

Storage Needs Analysis, Free Engineering Cad Design Service, Mobile And Architectural Solutions
Customizable Shelves, Bins, Baskets, Drawers, Dividers, Pull Out And Rotating Catheter Hooks (Fifo Glides)
Pull Out Suture Modules, Secure-A-Scope™ Easy Access Endoscopy Holders, Custom Small Scope Holders
LEDs, UV Lighting, Timed Fans, Roll Top Or Hinged Glass Doors, Medical Grade Laminates
14 Gauge Powder Coated Metal, Stainless Steel, ABS Plastic, Electronic Security, Tracking Software, Scope Tracker™

MASS

MEDICAL STORAGE



MBE
Minority
Business
Enterprise

MASS PUTS YOU IN CONTROL

Contents

MASS™ Philosophy	2,3
MASS Metal™	
Exchange Carts	4, 5
Wall Storage Cabinets.....	6
Exchange Components	7
Exchange Cart Options	8
Carts for MRI	9
Endoscopy	
Secure-A-Scope™ Storage System....	10-12
Procedure Carts	13
Scope Transport Carts	13
Cardiac Cath Lab - EP Lab	
Wall Storage Cabinets.....	14
Wall Storage Cabinet Options.....	15
Mobile Cath Lab Storage.....	16
Procedure Carts	17
Surgery – Ambulatory Surgery	
MASS Metal™ Exchange Carts.....	18
Surgical Supplies "To Go".....	19
Additional MASS™ Models	20
Surgical Supply Wall Cabinets	21
Radiology – Angiography	
Interventional Supply Storage Cabinets....	22
Wall Storage Cabinets.....	23
Mobile Interventional Supplies.....	24
Radiology Supply Carts	25
Metal Cabinets and Carts.....	26
Radiology – CT	
CT Supply Storage	27
Design Worksheet	
MASS™ Small Series Carts	28, 29
Standard Cabinets.....	30
Metal Exchange Cabinets.....	31
Metal Exchange Carts	32
Typical Rooms.....	33
Accessories/Options	34, 35

Specifications are subject to change without notice.

MASS PUTS YOU IN CONTROL

SERVICES:

Storage Needs Analysis
Free Engineering CAD Design Service
Mobile and Architectural Solutions

MATERIALS:

Medical Grade Laminates
14 Gauge Powder Coated Metal
Stainless Steel
ABS Plastic

FEATURES:

Customizable Shelves, Bins,
Baskets, Drawers, Dividers
Pull Out and Rotating
Catheter Hooks (FIFO Glides)
Pull Out Suture Modules
Secure-A-Scope™ Easy Access
Endoscopy Holders
Custom Small Scope Holders
LEDs, UV Lighting, Timed Fans
Roll Top or Hinged Glass Doors
and much more.....

STATE OF THE ART INVENTORY MANAGEMENT:

Electronic Security
Tracking Software

SCOPE TRACKER™

INFECTION CONTROL COMPLIANCE:

SATISFY JOINT COMMISSION AND
MANUFACTURER STORAGE SPECS





Trust a reputable source.

MASS™ Medical Storage has been the choice for storage solutions in leading medical institutions around the world for more than 15 years. MASS™ is proud to partner with Aria Medical, Attania, Cook Medical, IMS, Merry X-Ray, Storage Systems Unlimited, and more. In addition, MASS™ continues to be an approved government supplier.

Get fast delivery. Compare lead times and you'll discover why more medical facilities rely on MASS™ Medical Storage.

Make better decisions.

Different departments have different needs. We can help identify the best storage solution for each, based on our experience with thousands of hospitals.

Simplify decision making.

If you're not sure of what you need, start by looking at the pre-configured packages with options and accessories most commonly used by various departments. Call us for practical steps in getting started.

Benefit from smart design.

How people access and store medical equipment and supplies is critical. Ergonomics are considered in the design process. Each product is engineered to promote efficiency and maintain cleanliness with greater ease.

Buy quality. MASS™ has upheld a standard of detail and quality construction worthy of customer loyalty and capital investment. All products are backed by a 3-year Gold Seal Warranty.

Visit Our Web Site
MASSMedicalStorage.com



MASS METAL™ EXCHANGE CARTS

- Durable and light weight – Easy to move and use
- Premium 5" casters, front two locking for safety
- Interchangeable shelves, trays, and baskets to adapt to future needs
- High-impact rigid pvc wrap-around cart guard
- Four cart sizes to meet every need
- Heavy-duty, powder-coated 14 and 20 gauge steel construction
- No wasted space!

Design for
Today's
Storage Needs
Reconfigure for
Tomorrow's
Demands

MX6101DK
Full-Size Metal
Exchange Cart
with FlexLok™ Door and
optional Keyless Lock.
26"D x 45.12"W x 78.75"H





MX6101DK
Full Size Exchange Cart
with FlexLok™ Door and optional Keyless Lock.
26"D x 45.12"W x 78.75"H



MX6107
Half Size Exchange Cart
with FlexLok™ Door.
31"D x 28"W x 78.75"H



MX6102DK
Mid Size Exchange Cart
with FlexLok™ Door, with Stainless Steel Top
and optional Keyless Lock.
26"D x 45.12"W x 44"H



MX6108
Standard Size Exchange Cart
with FlexLok™ Door, with Stainless Steel
Top and optional Red Bumper.
26"D x 25.62"W x 44"H

MASS METAL™ **EXCHANGE CARTS**

Four cart sizes... Hundreds of options

- Mix and match interior components, trays, baskets, shelves and more!
- Easy to reconfigure for new packaging or procedures
- ABS Trays and Wire Baskets available in 3", 6", and 9" heights
- Components slide in and out easily on ABS side panels
- Easy to maneuver with lightweight construction and premium casters

**Visit Our
Web Site
MASSMedical
Storage.com**

Proudly Made



in the U.S.A.

MASS METAL™
Wall Storage Cabinets

MX4400D
Metal Exchange
Wall Storage
Cabinet
with FlexLok™ Door.
22"D x 41"W x
89.37"H



FIFOGLIDE™ CATHETER TRACKS
WITH ROTATING HOOKS



SLIDE-OUT SHELF



M4601
Upper Metal Wall
Cabinets
16"D x 41"W x 36"H



MX4401D
Lower Metal Exchange
Wall Cabinets
22"D x 41"W x 35.5"H



MX4402
Metal Exchange Half Cabinet
22"D x 21.62"W x 84.37"H



SLIDE-OUT SLOTSHELF™ WITH ADJUSTABLE DIVIDERS



ABS TRAYS WITH OPTIONAL DIVIDERS



WIRE BASKETS AVAILABLE IN THREE DIFFERENT SIZES



FIFOGLIDE™ CATHETER STORAGE MODULE



SLIDE-OUT SHELF



BINS AVAILABLE IN THREE CONVENIENT SIZES - 4", 6", 8" WIDTHS



SLIDE-OUT SUTURE MODULE



ELECTRONIC KEYLESS LOCK ADDS SECURITY AND CONVENIENCE

EXCHANGE COMPONENTS

- Select colored SlotShelf™ dividers and bins to coordinate interiors
- MASS™ modules make a difference! Baskets, trays, and shelves are 18.5" wide
- Interchangeable shelves, trays, and baskets - easily moved from carts to cabinets!

Contact Us Today for a QuikQuote™

800.593.1900



SIX INCH LOCKING METAL DRAWER



ID LABEL FOR BASKETS

EXCHANGE CART OPTIONS

Color code to improve organization and efficiency

- Color code carts for specific procedures
- Choose cart guard and door strip accent colors
- Select colored SlotShelf™ dividers and bins to coordinate interiors
- MASS™ modules make a difference! Baskets, trays, and shelves are 18.5" wide and easily moved from carts to cabinets!



SLIDE-OUT BIN MODULE



SLIDE-OUT SHELF



MX6108 RED



MX6108 BLUE



MX6108 BLACK



MX6108 GREEN Standard Size
Exchange Cart with FlexLok™ Door.
26"D x 25.62"W x 44"H



MX6108 GREEN
Pictured with closed FlexLok™ Door
and colored door strip.



**FRONT LOCKING PREMIUM
CASTER WHEELS**



SLIDE-OUT TRAYS WITH DIVIDERS



M3101HGMR
Full Size Modular Storage Cart
Hinged Doors with Glass Inserts.
26"D x 45.12"W x 79.25"H



M3101HGMR
Full Size Modular Storage Cart
Hinged Doors with Glass Inserts.
26"D x 45.12"W x 79.25"H

- Mix and match interior components to customize carts for specific supplies
- All exposed metal components and hardware non-ferrous
- Nurse's Cart
- Supply Cart
- Medication Cart

**Contact Us
Today for a
QuikQuote™
800.593.1900**

**If you don't
see what your
looking for,
call us!**



M3110
MASS™ Small Series Cart
22.5"D x 27"W x 44"H



FIFOGLIDE™ CATHETER TRACKS.
Rotating stainless steel hooks.



**MRI CONDITIONAL CASTERS WITH
STAINLESS STEEL BEARINGS**



STAINLESS STEEL HINGES

Secure-A-Scope™ Storage System

- Revolutionary new design sets the gold standard for scope storage and accessibility
- Rotating scope holders make loading and removing scopes easy, safe, and secure
- Scope holders engineered to protect scope heads and support umbilicals
- Back wall of cabinet padded vinyl to prevent damage to distal tips
- Removable plastic drip tray
- Filtered ambient air vents

NEW

Ask to see a demonstration in your hospital today.

Call MASS™ or find your local rep on our website.



M1200LHG SECURE-A-SCOPE™ STORAGE SYSTEM

Locking Hinged Door with Glass Inserts.
Holds 9 Flexible Endoscopes.
13.62"D x 40.87"W x 88.62"H



M1800 SECURE-A-SCOPE™ STORAGE SYSTEM

with FlexLok™ Door.
Holds 18 Flexible Endoscopes.
18"D x 40.87"W x 95.25"H

Secure-A-Scope™ Exclusively From MASS™

Unique, Rotating Scope Holders

The Storage System To Protect All Your Scopes

- Cabinets to store 4, 8, 9, or 18 flexible Endoscopes
- Door Options - all models
 - FlexLok™ Door
 - Hinged Doors with Glass Inserts
 - Solid Hinged Doors



M1200
SECURE-A-SCOPE™
STORAGE SYSTEM
with FlexLok™ Door. Holds 9 Flexible Endoscopes.
12.87"D x 40.87"W x 94.12"H



M1202
SECURE-A-SCOPE™
STORAGE SYSTEM
with FlexLok™ Door. Holds 4
flexible Endoscopes.
12.87"D x 21.62"W x 94.12"H



M1802
SECURE-A-SCOPE™
STORAGE SYSTEM
with FlexLok™ Door. Holds 8 Flexible
Endoscopes. 18"D x 21.62"W x 95.25"H



M2000LHG
Pass-through SECURE-A-SCOPE™
Scope Cabinet
with Locking Hinged Glass Doors. Holds 4 scopes on each side wall for capacity of 8 scopes. 23.12"D x 40.87"W x 93"H

- Cabinets to store 4 or 9 Bronchoscopes, Cystoscopes or Ureteroscopes



M1208
SECURE-A-SCOPE™
STORAGE SYSTEM
with FlexLok™ Door. Holds 9 small diameter scopes. 12.87"D x 40.87"W x 77"H



M1204
SECURE-A-SCOPE™
STORAGE SYSTEM
with FlexLok™ Door. Holds 4 small diameter scopes. 12.87"D x 21.62"W x 77"H



- Vertically and independently adjustable upper and lower scope supports
- Holds 4-8 small diameter scopes
- Hinged, 3-point locking, clear hinged door
- Wall mounted for loading and removing scopes easily, safely and securely
- Silicone inserts gently cushion and support any scopes. The inserts are easily, quickly cleaned or replaced
- Available for immediate shipment

ENDOSCOPY PROCEDURE CARTS



M3103

Full Size ERCP Cart

with FlexLok™ Door on upper and lower sections.
26"D x 45.12"W x 71"H



M3104

Mid Size ERCP Cart

with FlexLok™ Door.
26"D x 45.12"W x 42.5"H



M3102ED

Dilator Storage Cart

with FlexLok™ Door.
26"D x 45.12"W x 42.5"H



M1201HG

Small Diameter Wall Mounted SECURE-A-SCOPE™ Scope Cabinet

with hinged, 3-point locking, clear hinged door. Holds 4-8 small scopes.
11.25"D x 19.125"W x 48.125"H, 51 lbs

SCOPE TRANSPORT CARTS

- Carts available with four or nine autoclavable trays (lids included)
- Heavy-duty handles for easier mobility



M3124

Scope Transport Cart

22.62"D x 27"W x 44"H



M6204SS

Stainless Steel Scope Transport Cart

21"D x 24.4"W x 35.75"H

This Cart is Steam or Machine Washable!

WALL STORAGE CABINETS

Flexible • Adaptable • Expandable

- More interior storage capacity
- Manages 735 catheters depending on package size
- Store all your cath lab supplies with no wasted space
- Create unique interiors for specific supplies
- Exchange System also available in melamine carts and cabinets

Visit Our
Web Site
MASSMedical
Storage.com



Standard System Modules Exchange System Modules

MX2200D

Exchange Wall Storage Cabinets

with FlexLok™ Door. 22"D x 40.87"W x 91.25"H



M1600

Wall Storage Cabinets

with FlexLok™ Door, Sloped tops pictured. 16"D x 40.87"W x 89.5"H

M2200

Wall Storage Cabinets

with FlexLok™ Door, Sloped tops pictured. 22"D x 40.87"W x 91.25"H



M2200HG

Wall Storage Cabinets

Hinged Doors with Glass Inserts, flat top pictured. 22.75"D x 40.87"W x 84"H

M1600HG

Wall Storage Cabinets

Hinged Doors with Glass Insert, flat top pictured. 16.75"D x 40.87"W x 84"H

WALL STORAGE CABINET OPTIONS

Door options:

- Hinged with Glass Inserts
- Solid Hinged Doors
- FlexLok™ Door (roll down)
- No Door



**M1602
Half Wall
Storage
Cabinets**

16"D x 21.62"W
x 89.5"H

**M2202
Half Wall
Storage
Cabinets**

22"D x 21.62"W x
91.12"H

Half Cabinet is 21.6" wide, but has over 17 cu. ft. of interior storage space.

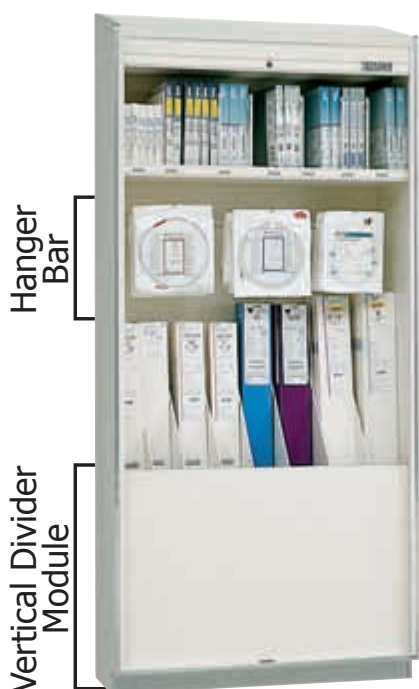

**VERTICAL DIVIDER
MODULE FOR LONG
BOXES.**

**SLIDE-OUT
VERTICAL
DIVIDER
MODULE
FOR EASY
ACCESS OF
LONG BOXES.**

Slide-out Vertical
Divider Module



MOBILE CATH LAB STORAGE

- Create a totally mobile cath lab storage system
- More storage capacity than any other mobile storage space
- Fifth wheel provides greater support, easier rolling, and better directional control



M3101D
Full Size Divided Modular Storage Cart
with FlexLok™ Door. 26"D x 45.12"W x 79.25"H



M3101DHG
Full Size Divided Modular Storage Cart
Hinged Doors with Glass Inserts.
26"D x 45.12"W x 79.25"H



M3101
Full Size Modular Storage Cart
with FlexLok™ Door. 26"D x 45.12"W x 79.25"H



MX3101DK
Full Size Exchange Cart
with FlexLok™ Door. 26"D x 45.12"W x 79.25"H



M3101
Full Size Modular Storage Cart
with FlexLok™ Door. 26"D x 45.12"W x 79.25"H



MX3101DK
Full Size Exchange Cart
with FlexLok™ Door. 26"D x 45.12"W x 79.25"H



M3102
Mid-Size Modular Storage Cart
with FlexLok™ Door.
26"D x 45.12"W x 42.5"H



MX3106DK
Mid-Size Exchange Cart
with FlexLok™ Door, Keyless Lock, and Stainless Steel Top and Rail. 26"D x 45.12"W x 43.5"H

PROCEDURE CARTS

- Stock one cart with all the supplies you need for a specific procedure
- The right size cart for every task
- Customized interiors and accessories
- Unlimited design options
 - Stent Cart
 - PTCA
 - Pacemaker Cart
 - Pediatric Supplies
 - Computer Cart
 - Emergency Cart
 - Equipment Cart
 - Bedside Recovery Cart



MX6101DHG
Full Size Metal Exchange Cart
Hinged Doors with Glass Inserts. Also pictured: Suture Module, Locking six inch Metal Drawer, and three FifoGlide™ Catheter Modules.
26"D x 45.12"W x 78"H



M3110
MASS™ Small Series Cart
22.62"D x 27"W x 44"H

MASS METAL™

EXCHANGE CARTS GET
THE JOB DONE



**SLIDE-OUT SLOTSHELF™
WITH ADJUSTABLE
DIVIDERS**



**ABS TRAYS WITH OPTIONAL
DIVIDERS**



**FIFOGLIDE™ CATHETER
STORAGE MODULE**



**ABS SIDE PANELS ALLOW
EASY EXCHANGE**



MX6101DHG

Full Size Metal Exchange Cart

Hinged Doors with Glass Inserts.
26"D x 45.12"W x 78"H



MX6107

**Half Size Metal
Exchange Cart**

with FlexLok™ Door.
31"D x 28"W x 78.75"H



MX6102DK

Mid Size Metal Exchange Cart

with FlexLok™ Door and optional Keyless Lock.
26"D x 45.12"W x 44"H



MX6108

**Standard Size Metal
Exchange Cart**

with FlexLok™ Door.
26"D x 25.62"W x 44"H

ARTHROSCOPY



ENT



GENERAL SURGERY



SURGICAL SUPPLIES "TO GO"

- Trays, baskets, and shelves slide in and out quickly
- Create a totally mobile storage system
- Move supplies quickly and easily where needed
- Reduce inventory, save money
- 14 and 20 gauge powder-coated steel
- Lightweight and easy to transport
- ABS side panels permit easy module exchange
- Change is inevitable – choose the one storage system that adapts

LIVER



NEURO



ORTHO



THORACIC



VASCULAR



MX6101DK
Full Size Metal
Exchange Cart
with FlexLok™ Door
and optional Keyless Lock.
26"D x 45.12"W x 78.75"H

GEN. SUPPLY



GI



MX6107
Half Size Metal Exchange Cart
with FlexLok™ Door.
31"D x 28"W x 78.75"H

ADDITIONAL MASS™ MODELS TO COMPLETE YOUR MOBILE STORAGE SYSTEMS

Portable • Flexible • Functional

- Move supplies and instruments room to room effortlessly
- Consolidate inventory and eliminate duplication



MX6101K
Full Size Metal Exchange Storage Cart
with FlexLok™ Door and optional Keyless Lock.
26"D x 45.12"W x 78.75"H



M3101DHG
Full Size Modular Storage Cart
Hinged Doors with Glass Inserts.
26"D x 45.12"W x 79.25"H



M3101
Full Size Modular Storage Cart
with FlexLok™ Door.
26"D x 45.12"W x 79.25"H



MX6101K
Full Size Metal Exchange Storage Cart
with FlexLok™ Door, and optional Keyless Lock.
26"D x 45.12"W x 78.75"H



MX3101DK
Full Size Exchange Cart
with FlexLok™ Door and optional Keyless Lock.
26"D x 45.12"W x 79.25"H



MX3101DK
Full Size Exchange Cart
with FlexLok™ Door and optional Keyless Lock.
26"D x 45.12"W x 79.25"H



MX4400DHG
Metal Exchange Wall Storage Cabinet
Hinged Doors with Glass Inserts.
22.75"D x 41"W x 84.37"H



MX4402
Metal Exchange Half Cabinet
with FlexLok™ Door. 22"D x 21.62"W x 84.37"H

SURGICAL SUPPLY WALL CABINETS

- Hinged Doors with Glass Inserts providing visibility for all inventory
- Four door options (see page 15)
- Modular System allowing easy, rapid utilization or changes in components
- Easily secured to wall
- Full and half widths available
- Sloped or flat tops



MX4400D
Metal Exchange Wall Storage Cabinet
with FlexLok™ Door. 22"D x 41"W x 84.37"H



INTERVENTIONAL SUPPLY STORAGE CABINETS

Door options:

- Hinged with Glass Inserts
- Solid Hinged Doors
- FlexLok™ Door (roll down)
- No Door
- More interior storage capacity than any other medical storage...over 34 cu. ft.
- Interior modules to store every size package with no wasted space
- Maximize narrow spaces
- Half cabinet – 21.6" wide



**M1600HG
Wall
Storage
Cabinets**
Hinged Doors
with Glass
Inserts.
16"D x
40.87"W x
84"H

**M2200HG
Wall
Storage
Cabinets**
Hinged Doors
with Glass
Inserts.
22"D x
40.87"W x
84"H



**M2200
Wall Storage Cabinets**
with FlexLok™ Door. 22"D x 41"W x 91.25"H

**M1600
Wall Storage Cabinets**
with FlexLok™ Door. 16" D x 41"W x 89.5"H



(Pictured—Two each of M1601 and M2201 with 82" continuous counter top)

M1601
Upper Wall Cabinets
16"D x 40.87"W x 37.12"H

M2201
Lower Wall Cabinets
22"D x 40.87"W x 35.5"H

WALL STORAGE CABINETS

- Creative designs to fit unique environments
- Organize your vast interventional supply inventory
- Complete your lab and maximize storage with upper and lower cabinets and MASS™ modular components

Contact Us Today for a QuikQuote™

800.593.1900



**VERTICAL DIVIDER
MODULE FOR
LONG BOXES**

Also available in a pullout/slideout module



**SLOTSHELF™ MODULES
WITH OPTIONAL
COLORED DIVIDERS**



**KEY-LOCKED FLEXLOK™
TAMBOUR DOOR ROLLS
UP INTO TOP OF
CABINET, SHOWN WITH
CLOSED DOOR**



**BINS AVAILABLE IN
THREE CONVENIENT
SIZES - 4", 6", 8"
WIDTHS**



**WIRE BASKETS
AVAILABLE IN NINE
DIFFERENT SIZES**



**EASY-OPEN DRAWERS
WITH ADJUSTABLE
DIVIDERS**

MOBILIZE INTERVENTIONAL SUPPLIES

- Create a totally mobile storage system
- More storage capacity than any other mobile storage system
- Door options:
 - Hinged with Glass Inserts
 - Solid Hinged Doors
 - FlexLok™ Door (roll down)
 - No Door
- Mix and match interior components for effective product storage utilization



M3101D
Full Size Divided Modular Storage Cart
with FlexLok™ Door. 26"D x 45.12"W x 79.25"H



MX6101K
Full Size Exchange Storage Cart
with FlexLok™ Door, and optional
Keyless Lock.
26"D x 45.12"W x 79.25"H



M3101DHG
Full Size Divided Modular Storage Cart
Hinged Doors with Glass Inserts.
26"D x 45.12"W x 79.25"H



M3101
Full Size Modular Storage Cart
with FlexLok™ Door. 26"D x 45.12"W x 79.25"H



**SLIDE-OUT
VERTICAL
DIVIDER
MODULE
FOR EASY
ACCESS OF
LONG BOXES**

Slide-out Vertical
Divider Module



RADIOLOGY SUPPLY CARTS

- Unlimited design options
- Unique interior modular components
- Easy exchange of components on ABS Side Panels

Standard System
Full Width Shelves

Exchange System
Slide-out Components



MX3101DK
Full Size Exchange Cart
with FlexLok™ Door and Keyless Lock.
26"D x 45.12"W x 79.25"H



MX3106DK
Mid-Size Exchange Cart
with FlexLok™ Door, Stainless Steel Top
and Rail and optional Keyless Lock.
26"D x 45.12"W x 42"H



OPTIONAL KEYLESS LOCK



**ABS TRAY WITH
OPTIONAL DIVIDERS**



M3102
Mid-Size Modular Storage Cart
with FlexLok™ Door.
26"D x 45.12"W x 42"H

METAL CABINETS AND CARTS FOR RADIOLOGY

- Modules interchangeable between cabinets and carts
- Durable 14 and 20 gauge steel construction
- Wire baskets, trays, shelves, and SlotShelf™ module with adjustable dividers



MX6102DK
Mid Size Metal Exchange Cart
with FlexLok™ Door and optional Keyless Lock.
26"D x 45.12"W x 44"H



MX6108
Standard Size Metal Exchange Cart
with FlexLok™ Door.
26"D x 25.62"W x 44"H



MX4400
Metal Wall Storage Cabinet
with FlexLok™ Door.
22"D x 41"W x 84.75"H



MX4400DHG
Metal Exchange Wall Storage Cabinet
Hinged Doors with Glass Inserts.
22"D x 41"W x 84.75"H



MX4402
Metal Exchange Half Wall Storage Cabinet
with FlexLok™ Door.
22"D x 21.6"W x 84.37"H



MX6107
Half Size Metal Exchange Cart
with FlexLok™ Door.
31"D x 28"W x 78.75"H



MX6101DHG
Full Size Metal Exchange Cart
Hinged Doors with Glass Inserts.
26"D x 45.12"W x 78.75"H



M1600
Wall Storage Cabinets
with FlexLok™
Door. 16"D x
40.87"W x 89.5"H

M2200
Wall Storage Cabinets
with FlexLok™
Door. 22"D x
40.87"W x 91.25"H

CT SUPPLY STORAGE

- Wall storage cabinets organize your room and eliminate clutter
- Custom cabinets without the custom price
- Mobile supply carts– the ultimate convenience
- Unlimited design possibilities
- MASS™ Small Series Carts (below) available in over 500 different configurations

Contact Us Today for a QuikQuote™

800.593.1900



M3110
MASS™ Small Series Cart
22.62"D x 27"W x 44"H



MX3106DK
Mid-Size Exchange Cart
with FlexLok™ Door, Stainless Steel Top and Rail and optional Keyless Lock.
26"D x 45.12"W x 43.5"H



M3101
Full Size Modular Storage Cart
with FlexLok™ Door.
26"D x 45.12"W x 79.25"H

- Hundreds of custom configurations available
- 13 popular models shown below
- Create your perfect small cart
- Unique interior modules and accessories to match your needs
- Use the design worksheet on the next page to create your own

Biopsy
Isolation
OR
X-Ray
CT
ICU
IV

GI Lab
Chemo
Supply
Lavage
Radiology
Pacemaker
Labor/Delivery

Emergency
Oncology
Anesthesia
Monitor
Bedside
Endoscopy
Computer

Equipment
Dialysis
Cath Lab
Procedure
MRI

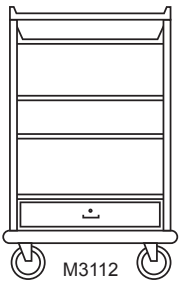

M3112

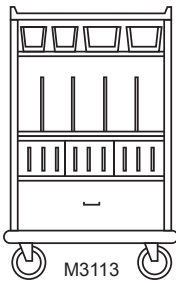

M3113

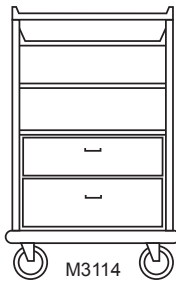

M3114

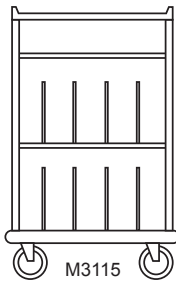

M3115

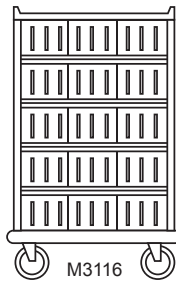

M3116

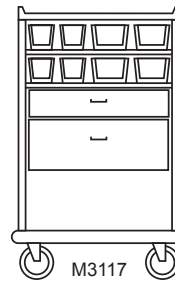

M3117

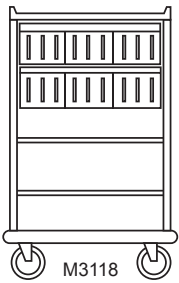

M3118

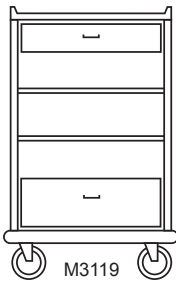

M3119

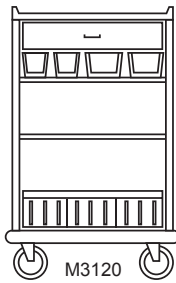

M3120

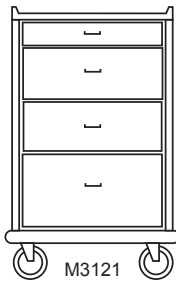

M3121

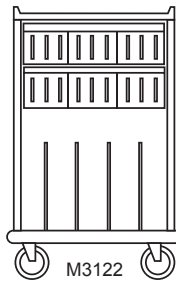

M3122

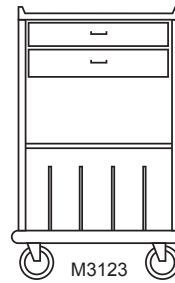

M3123

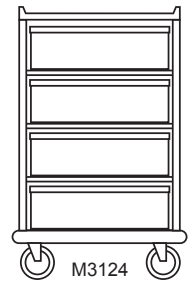

M3124



**CHOICE OF
DRAWERS**
4", 6", 8", 12"



M3110
MASS™ Small Series Cart
22.62"D x 27"W x 44"H

BUILD YOUR OWN CART

(Electronic version available by request)

1. Cut out the desired component.
2. Paste or tape component on cart.
3. Build your Small Cart, fax to MASS™ at (913) 438-2275 for QuikQuote™.

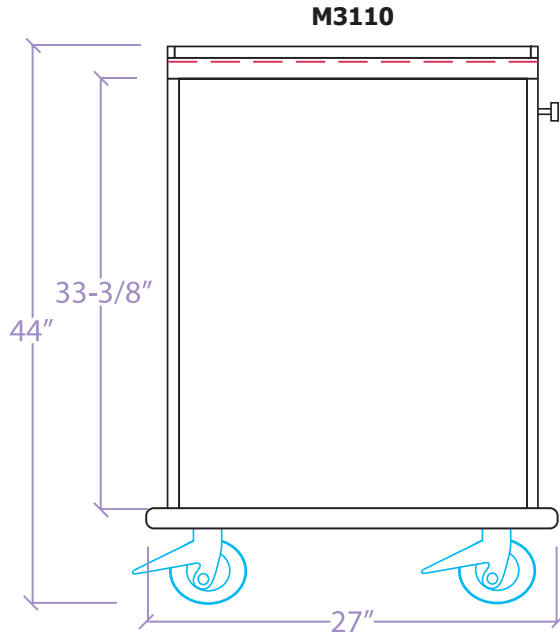

Considerations

- Any individual locking drawer requires a stationary LokShelf™, SlotShelf™ or Bin Module above for anchoring the lock.
- Any drawer below a Slide-out Shelf or ABS Basketub™ requires a LokShelf™ above.
- To provide adequate clearance, allow 0.25" above and below each drawer. (not included in above component drawings)
- Allow a minimum of 3" atop a Keyboard Shelf.

Model Number Designation: _____

Customer/Project ID: _____

Designer/Sales Rep.: _____

Contact Email: _____

Contact Phone: _____

BIN MODULE



SLOTSHELF™



LOKSHELF™



SLIDE-OUT KEYBOARD/ EQUIPMENT SHELF



ABS BASKETUB™

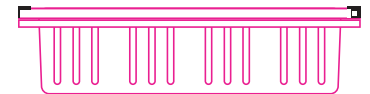

4" DRAWER



6" DRAWER



8" DRAWER



12" DRAWER



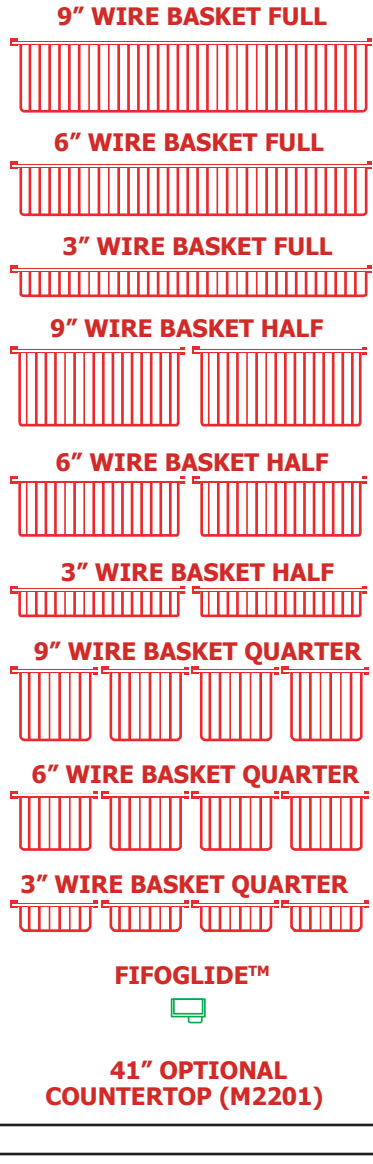
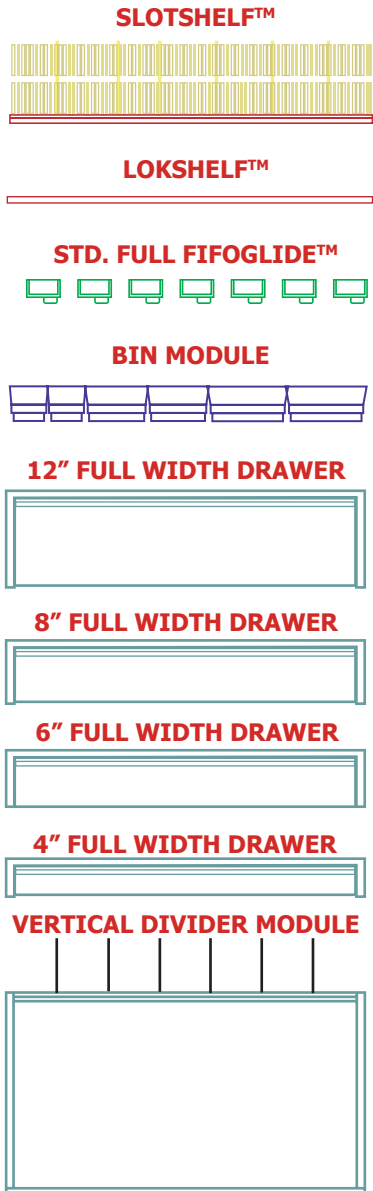

Considerations

- All baskets require a LokShelf™ above for mounting.
- All Bin Modules require a LokShelf™.
- FlexLok™ doors are standard equipment. Otherwise designate HG (hinged door w/ glass), H (hinged door, solid) or NFL (no door) at the end of desired Model Number.

Model Number Designation: _____

Customer/Project ID: _____

Designer/Sales Rep.: _____

Contact Email: _____

Contact Phone: _____

BUILD YOUR OWN CABINET

FULL-WIDTH COMPONENTS

(Electronic version available by request)

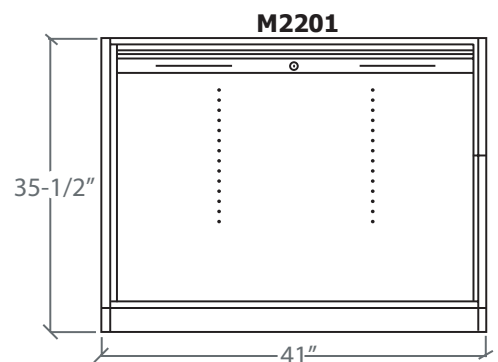
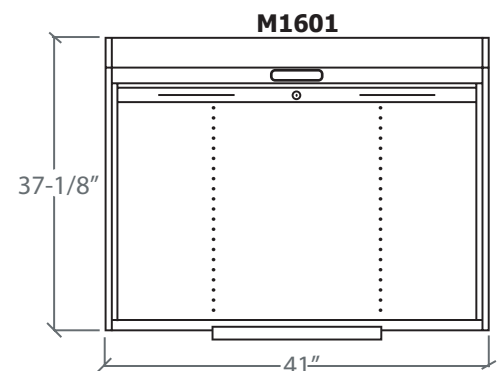
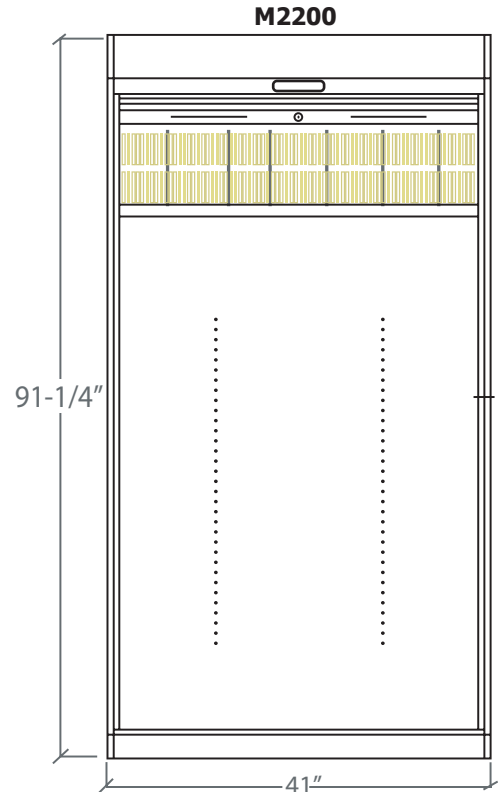

BUILD YOUR OWN CABINET

(Electronic version available by request)

1. Cut out the desired component.
2. Paste or tape component on cabinet.
3. Build your cabinet, fax to MASS™ at (913) 438-2275 for QuikQuote™.

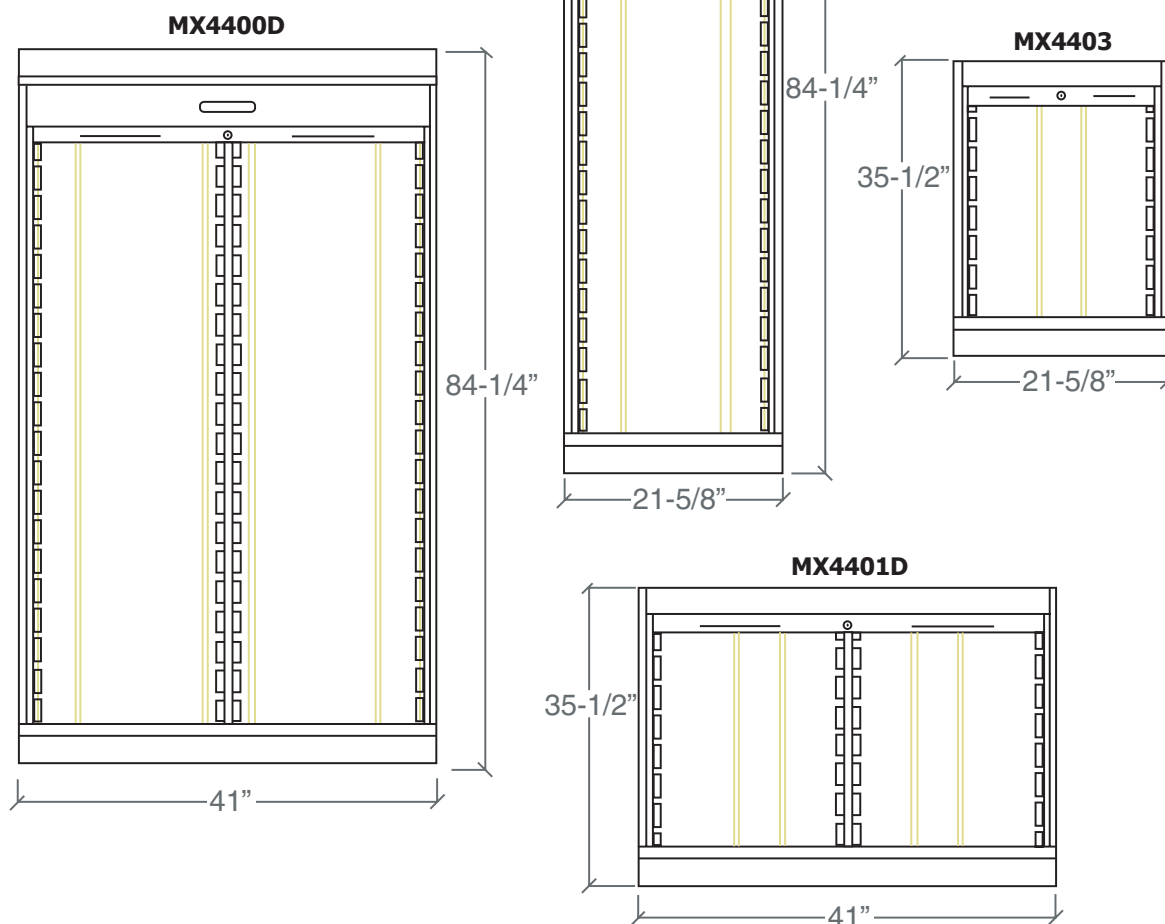

Considerations

- The FifoGlide™ Module is fixed to the back cabinet wall and not readily repositioned. The FifoGlide™ extend out, but not the shelf they're mounted to.
- The 6" Locking Metal Drawer is a fixture unable to be repositioned.

Model Number Designation: _____

Customer/Project ID: _____

Designer/Sales Rep.: _____

Contact Email: _____

Contact Phone: _____

SLOTSHELF™



SLIDE-OUT SHELF



BIN MODULE



3" ABS TRAY



6" ABS TRAY



9" ABS TRAY



3" WIRE BASKET



6" WIRE BASKET



9" WIRE BASKET



FIFOGLIDE™ MODULE



6" LOCKING METAL DRAWER



SCOPE TRANSPORT TRAY



SUTURE MODULE

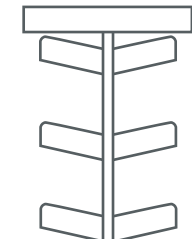

FIFOGLIDE™



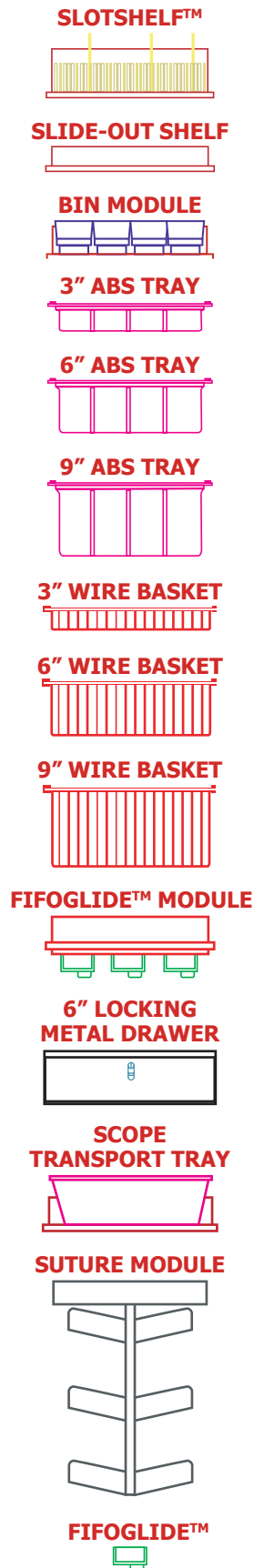

BUILD YOUR OWN CART

(Electronic version available by request)

1. Cut out the desired component.
2. Paste or tape component on cart.
3. Build your Cart, fax to MASS™ at (913) 438-2275 for QuikQuote™.

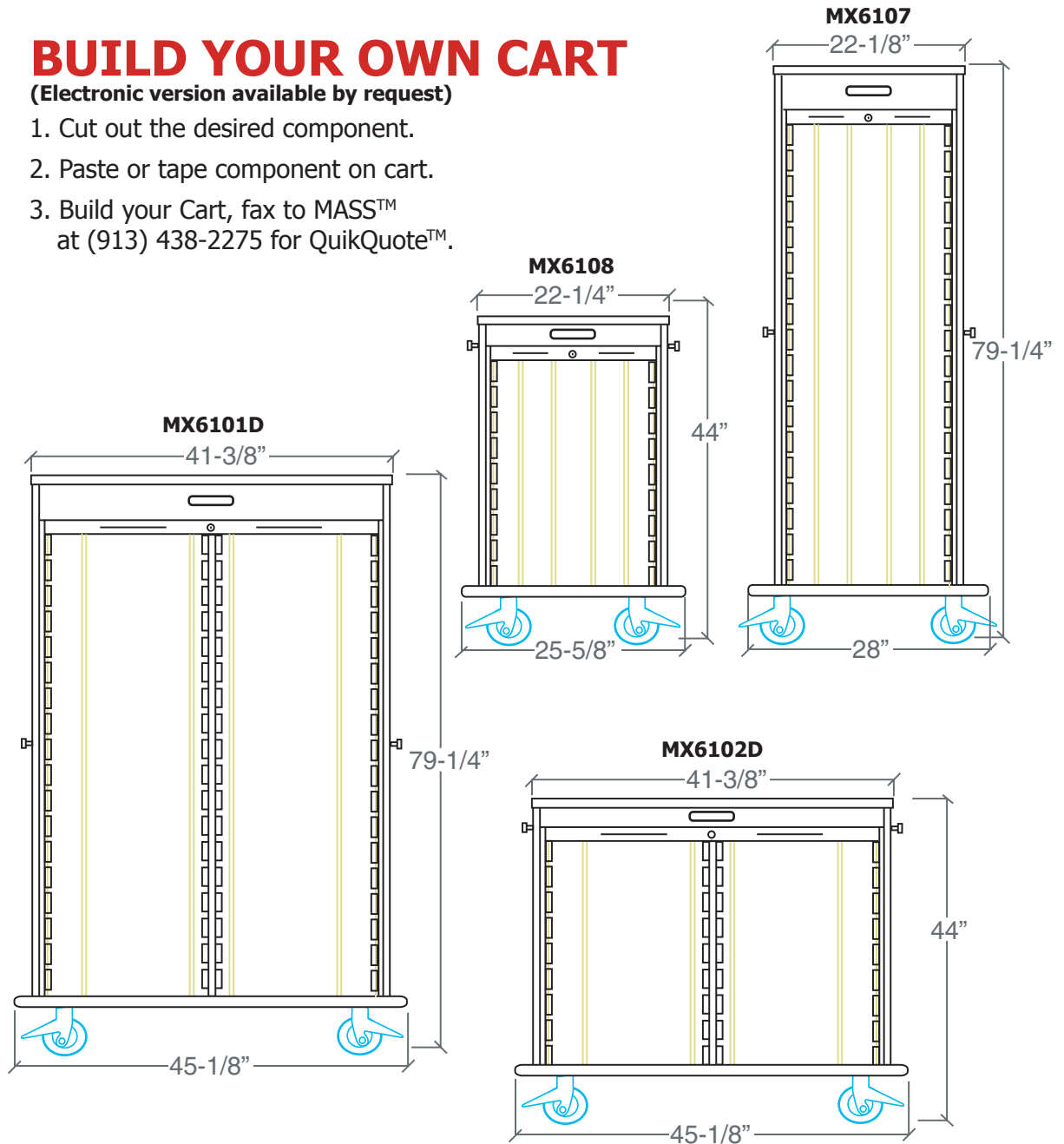

Considerations

- The FIFOGlide™ Module is fixed to the back cabinet wall and not readily repositioned. The FIFOGlide™ extend out, but not the shelf they're mounted to.
- The 6" Locking Metal Drawer is a fixture unable to be repositioned.

Model Number Designation: _____

Customer/Project ID: _____

Designer/Sales Rep.: _____

Contact Email: _____

Contact Phone: _____

TYPICAL CARDIAC CATH LAB & INTERVENTIONAL RADIOLOGY

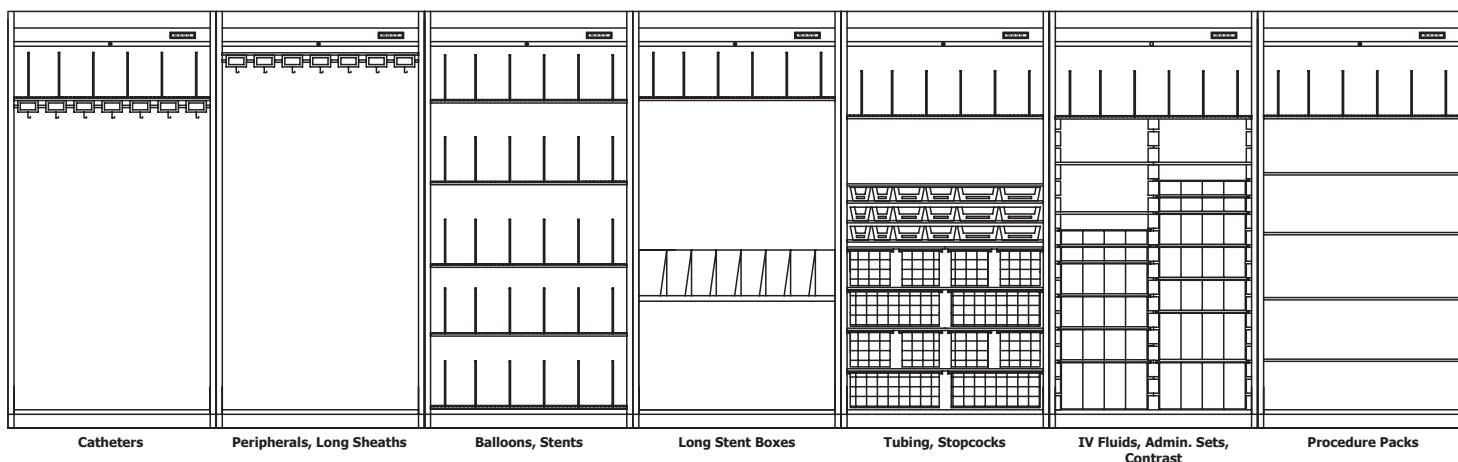

TYPICAL METAL EXCHANGE SURGERY CARTS

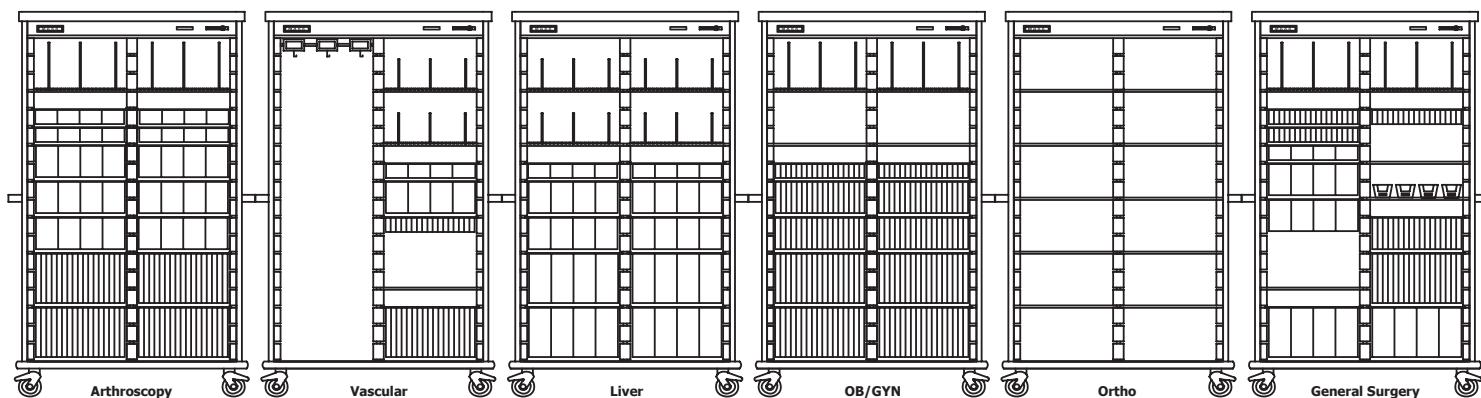

TYPICAL MOBILE SURGERY STORAGE DESIGNS

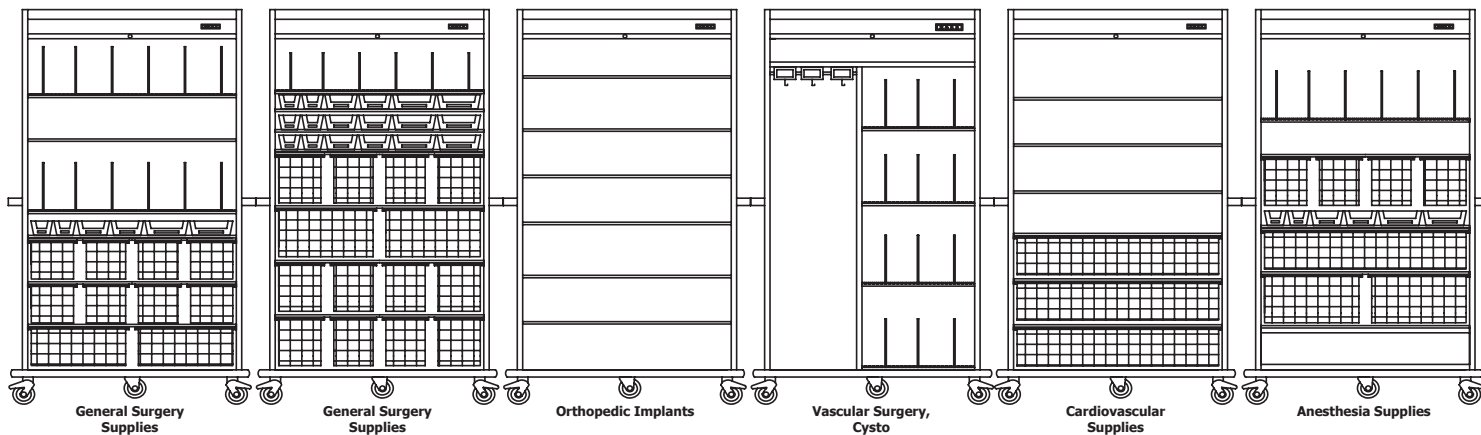



**THREE BIN SIZES:
4", 6", AND 8" WIDE**



**EQUIPMENT ACCESS DOOR
(MASS™ SMALL SERIES
CART ONLY)**



IV POLE EXTENDS TO 36"



ID LABEL FOR BASKETS



**ELECTRONIC KEYLESS
LOCK ADDS SECURITY
AND CONVENIENCE**



**SLOTSHEF™ MODULES
WITH OPTIONAL COLORED
DIVIDERS**



**AUTOCCLAVABLE SCOPE
TRAY AND LINER**



**SIX INCH LOCKING METAL
DRAWER**



**METAL SHELF OR CLEAR
ACRYLIC DIVIDED TRAY
FOR ADJUSTABLE ABOVE
CART STORAGE OF SMALL
ITEMS**



**FIFOGLIDE™ CATHETER
STORAGE MODULE**



**FOLD-DOWN
WRITING SHELF
16 3/16" X 19 1/8"**



**GLOVE BOX HOLDER
TWO OR THREE
BOX HOLDERS**



**SLIDE-OUT SHELF
FOR KEYBOARD OR
EQUIPMENT**



**CORD MANAGER
INDIVIDUALLY WRAP
POWER CORDS AND
LEADS. ELIMINATE
TANGLED CORDS**



**KEYLESS LOCK
OPTIONAL ON ALL
CARTS EXCEPT MASS™
SMALL SERIES CARTS**



**POWER STRIP
HOSPITAL-GRADE SIX-PLUG.
ACCESS VIA CORD PORTS IN
BACK OR SIDE WALL**

M3103

Full Size ERCP Cart
with FlexLok™ Door
on upper and
lower sections.
26"D x 45.12"W
x 71"H



Task Light



Slide-out Vertical
Divider Module



**SLIDE-OUT VERTICAL DIVIDER
MODULE FOR EASY ACCESS OF
LONG BOXES**

- Enhance the efficiency of your MASS™ carts and cabinets
- Other accessories available

**Contact Us
Today for a
QuikQuote™
800.593.1900**

**If you don't
see what your
looking for,
call us!**



Hanger Bar

Vertical Divider Module

**VERTICAL DIVIDER
MODULE FOR LONG
BOXES**



**SLOTSHELF™ MODULES
WITH OPTIONAL
COLORED DIVIDERS**



**OPTIONAL COLORED
DECOR STRIP HANDLE**

**FLEXLOK™ DOOR WITH
KEY LOCKED DOOR
ROLLS UP INTO TOP OF
CABINET. (SHOWN IN
DOWN POSITION)**



Suture Module

**SLIDE-OUT SUTURE
MODULE WITH
MAGNETIC METAL
DIVIDERS**

VISIT OUR WEBSITE TODAY

MASS MEDICAL STORAGE

NEW PRODUCTS



LEARN MORE

QUIKQUOTE



24-Hour Quote
Turn-Around

O.E.M. Partners

Cook Medical
IMS
Storage Systems
Unlimited



Arthroscopy Vascular Liver
(800) 593-1900 • www.MASSMedicalStorage.com

MASS
MEDICAL STORAGE

7848 Barton Street
Lenexa, KS 66214

800-593-1900
Fax: 913-438-2275